



WRE-CA Canon® aperture controller

WRE-CA lens panel – WRS series

INSTRUCTION MANUAL

EN

Please read this manual carefully before using the Cambo WRE-CA lens panel!

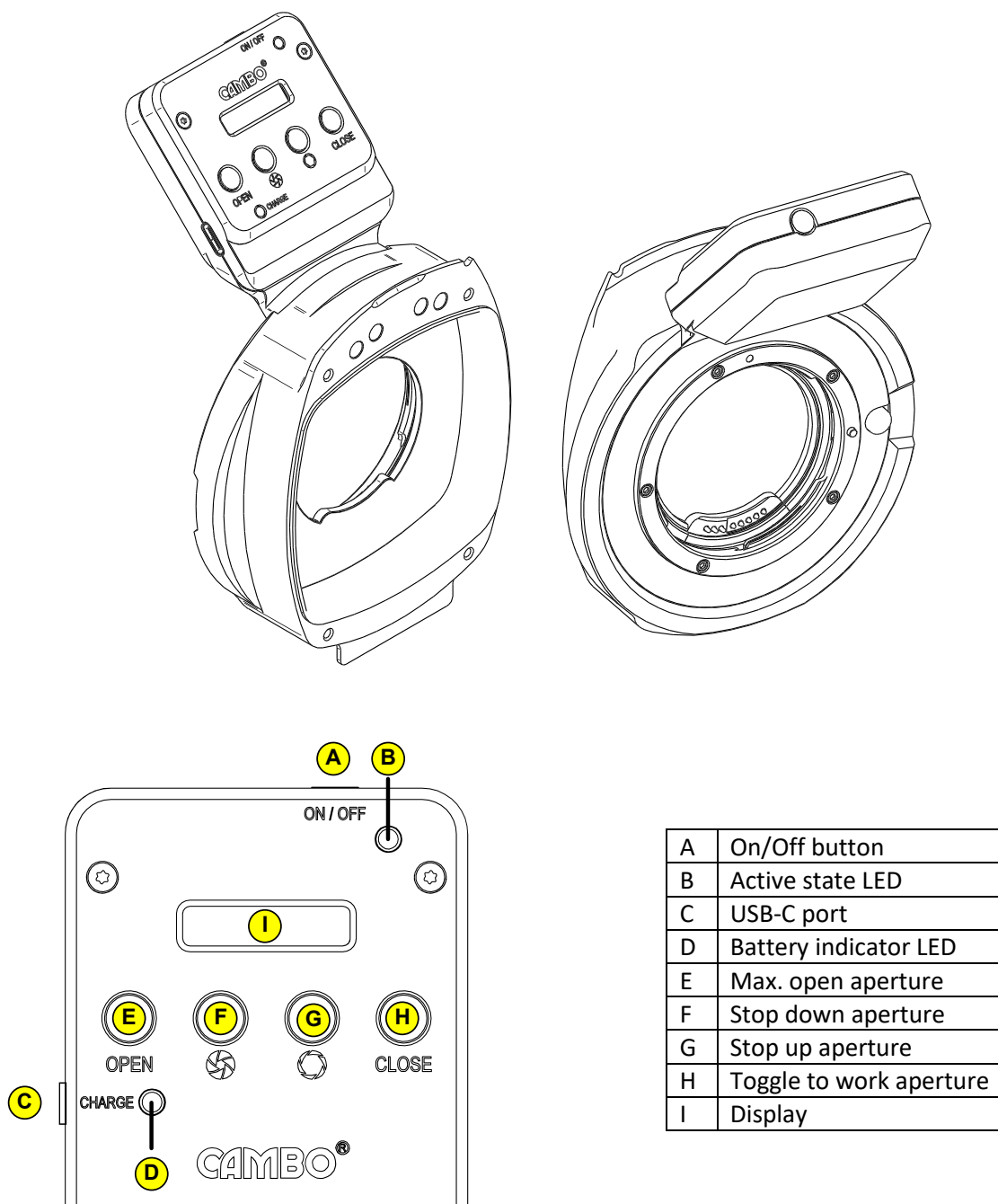

Figure 1: WRE-CA user interface

User instructions



The WRE-CA is compatible with Cambo WRS and Phase One XT camera systems. To make good use of EF lenses a digital back with on-sensor shutter is required.

1. Mount a Canon lens to the lens panel by aligning the red dot and turning the lens counter clockwise until the lens snaps in the lens lock.
2. Mount the lens panel to the WRS camera, please ensure that the lens panel mount handles are closed completely.
3. Press and hold on/off button (A) for 3 seconds to switch on the WRE-CA, active state LED (B) will turn blue to indicate the WRE-CA is on. Please note: The lens panel goes to standby-modus after 5 minutes. The aperture will not change during stand by.
4. When the lens panel is switched on, the last selected aperture is shown, for example; F/32.
5. Press (E) to toggle to the largest aperture opening, for example; F4
6. Press (F) to stop down the aperture
7. Press (G) to stop up the aperture
8. The last selected aperture set by using (F) or (G) is remembered by button (H)
9. Press (E) and (H) to toggle between the largest aperture and the set aperture.

Battery life/charging

Battery capacity is shown by the battery indicator LED (D). If battery capacity drops below 10% the LED will turn red to indicate it is time to charge. Use USB-C port (C) to charge. During charging the indicator will turn from red to blue, blue indicates charging, the LED will turn green when fully charged.

Warnings:

-  Before using the mounted WRE-CA lens panel, check if the mount lens handles are fully closed.
-  When dismounting the lenspanel/lens always support the panel and/or lens.
-  Disclaimer: we are NOT licensed, approved or endorsed by Canon®, customers use at their own risk.